

For broken bag detection & environmental measure

Triboelectric Dust Switch

PFM Series



Features

- ▶ DUST SWITCH is working environment protection sensor which is possible to mount general-purpose small size dust collector to monitor the filter condition.
- ▶ Light weight and compact (amplifier integrated)
- ▶ No difficult adjustment required
- ▶ NPN output possible to connect directly with PLC

Application example

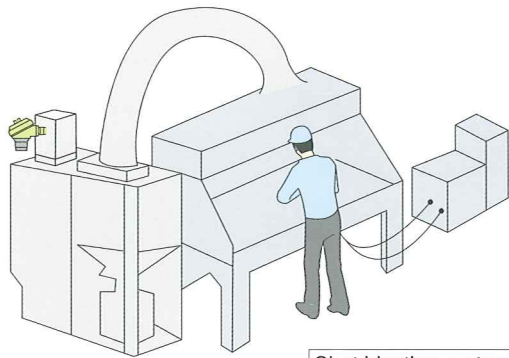

Shot blasting system

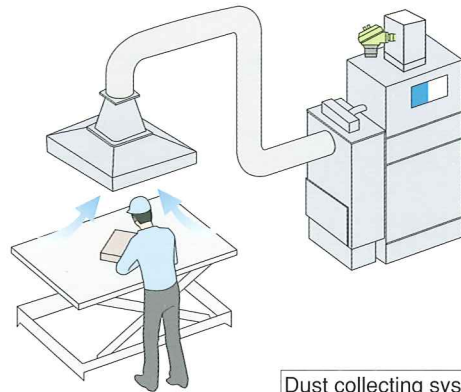

Dust collecting system

Specifacaton

| | |
|-------------------|---|
| Model | PFM-DSW10 |
| Construction | Sensor with integrated transducer |
| Power supply | 24VDC ±10% |
| Power consumption | 2W |
| LED display | Power lamp Green (ON=lighting) |
| | Detect lamp Red (ON=lighting) |
| Output signal | Open collector output 1 output (NPN) |
| Output capacity | Load voltage:DC5-30V, Laod current:50mA Max |
| Enclosure | Protection Rating:IP54 (Cover and lead outlet must be properly tightened) |

| | |
|-----------------------|------------------------------------|
| Dimension | Probe 50mm (below insulation part) |
| | insulator 50mm |
| Material | Probe : SUS304 |
| | insulator : Polyacetal |
| | Housing : Aluminum Casting |
| Allowable temperature | 0 to +55°C |
| Allowable humidity | 90%max. (Without condensatio) |
| Sensor mounting | G1/2 screw |
| Approx.Mass | 0.5kg |

Dimension (mm)

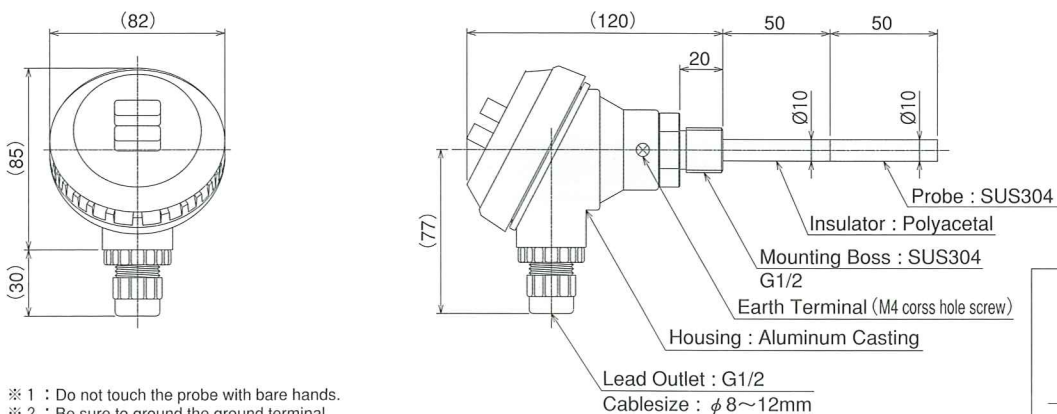

- ※ 1 : Do not touch the probe with bare hands.
- ※ 2 : Be sure to ground the ground terminal.
- ※ 3 : Make sure to close lead outlet so that outer air does not leak inside.
- ※ 4 : Insert wiring cable directly to terminal base without using crimp-type terminal tec.

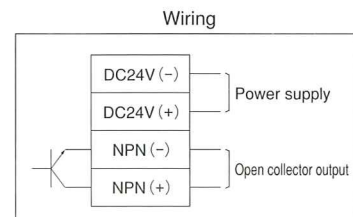

Specifications are subject to change without notice.
All Rights Reserved Copyright©2010, Matsushima Machinery Laboratory Co., Ltd.

Caution

 ● Read the instructions to ensure correct and suitable application of products.
 ● Contact our nearest sales office when using our products for any systems used in situations which may be life threatening.

Distributor



MATSUSHIMA Machinery Laboratory Co.,Ltd

HEAD SALES OFFICE / FACTORY
461 Norimatsu, Yahatanishi-ku, Kitakyushu,
807-0831, Japan
Tel: 81-93-691-3731 Fax: 81-93-691-3735

NAGOYA SALES OFFICE
Tokiwasotodoi Bldg., 9-14 Sotodoicho,
Atsuta-ku, Nagoya, 456-0013, Japan
Tel: 81-52-679-6301 Fax: 81-52-679-6305

TOKYO SALES OFFICE
Hohmest Funabashi Bldg., 3-36-28 Honcho,
Funabashi, Chiba, 273-0005, Japan
Tel: 81-47-424-9901 Fax: 81-47-424-9905

OSAKA SALES OFFICE
Daihatsu Bldg., 2-2-40 Katamachi,
Miyakojima-ku, Osaka, 534-0025 Japan
Tel: 81-6-6352-8011 Fax: 81-6-6352-8012

http://www.matusima.co.jp E-mail : info@matusima.co.jp